



KT-FLED60-R1A-UNV-8CSB-VDIM-W

COMPACT 60W GENERAL-PURPOSE LED FLOOD LIGHT

DESCRIPTION

Compact 60W General-Purpose LED Flood Light | 120–277V
 Input | 3000–5000K | White Housing | Multiple Mounting Options

APPLICATION

Building Mount or Ground Mount for outdoor illumination (landscapes, display signage, loading docks, building façades, pathways, parking areas, and other general site lighting requirements)



PRODUCT FEATURES

- Uniform, wide flood design (NEMA 7h x 7w distribution pattern)
- Heavy-duty, die cast aluminum housing featuring built-in glare visor and tempered glass lens
- Powered by Keystone 0–10V dimming LED drivers
- Keystone Color Select Technology: Adjustable CCT (3000K, 4000K, or 5000K)
- Built-in dusk-to-dawn photocell behind translucent 3/4" threaded plug with anti-yellowing agent
- Heavy-duty 1/2" knuckle mount with 90° adjustment and yoke mount options included
- Ambient operating temperature: –30°C/–22°F to 45°C/113°F
- UL listed for wet locations, IP65
- 0–10V dimming, 10% min
- Power Factor: >0.95
- THD: <20%
- LED chip lifetime: L70 >100,000 hrs @ 25°C/77°F ambient fixture temp
- Meets FCC Part 15, Part B, Class A standards for conducted and radiated emissions
- 18" input cable, pre-stripped
- Fixture impact rating IK07

ELECTRICAL SPECIFICATIONS

Catalog Number	Wattage	Lumens	Dimming	CCT*	Efficacy	CRI	Housing Color	Mounting	Input Voltage	Rated Life	Legacy Equivalent
KT-FLED60-R1A-UNV-8CSB-VDIM-W	60W	7320 lm	0–10V	3000K	122 lm/W	>80	White	Universal: 1/2" Knuckle or yoke	120–277V	50,000 hrs	250W MH
		8580 lm		4000K	143 lm/W						
		8040 lm		5000K	134 lm/W						

* Color Uniformity: CCT (Correlated Color Temperature) range as per guidelines outlined in ANSI C78.377-2017



KT-FLED60-R1A-UNV-8CSB-VDIM-W

COMPACT 60W GENERAL-PURPOSE LED FLOOD LIGHT

PHOTOMETRIC SPECIFICATIONS

ISOCANDELA PLOT

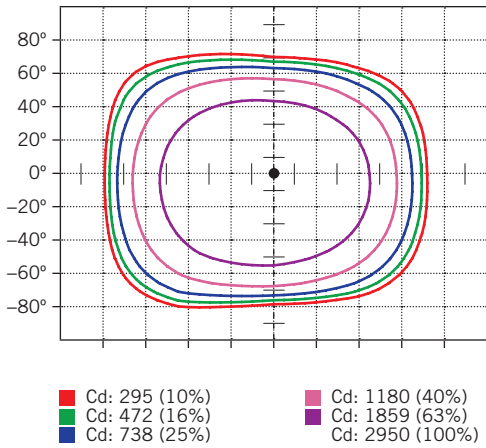

LUMINOUS INTENSITY DISTRIBUTION

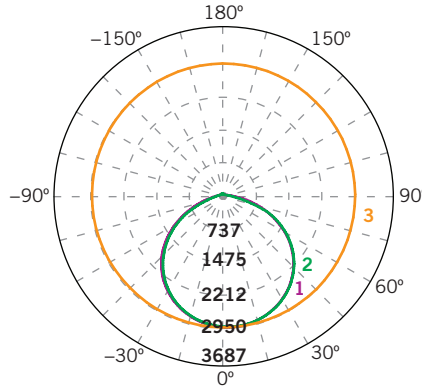

Average diffuse angle (50%): **114.9°**

- 1 Violet C0-C180
 - 2 Green C90-C270
 - 3 Orange G2
- Unit: cd

FLUX DISTRIBUTION

Zone	Lumens	% Luminaire
Forward Light	4,171 lm	50.8%
0°-30°	1,159 lm	14.1%
30°-60°	2,300 lm	28.0%
60°-80°	699 lm	8.5%
80°-90°	14 lm	0.2%
Back Light	3,981 lm	48.4%
0°-30°	1,146 lm	13.9%
30°-60°	2,200 lm	26.8%
60°-80°	624 lm	7.6%
80°-90°	11 lm	0.1%
Up Light	65 lm	0.8%
90°-100°	3 lm	0.0%
100°-180°	61 lm	0.7%

BUG* Rating	
Asymmetrical Luminaire Types	
Type I, II, III, IV	B3 U2 G2
Quadrilateral Symmetrical Luminaire Types	
Type V, Area Light	B3 U2 G1

* Backlight, Uplight, Glare

LIGHT DISTRIBUTION PATTERNS (Isometric view from above)

Building exterior mounted at
15', 30° below horizontal

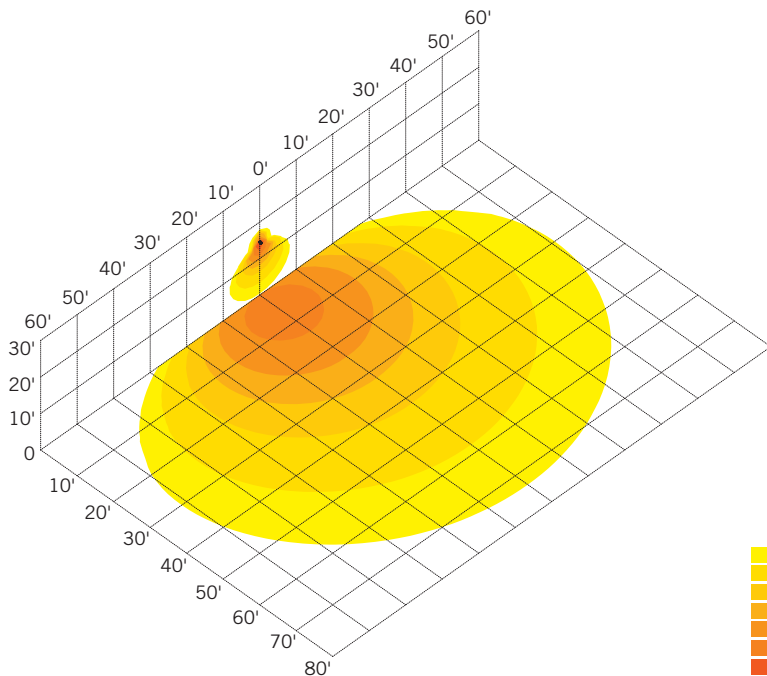

Ground mounted at 6" above ground,
10° above horizontal, shining towards building exterior wall at 20' away

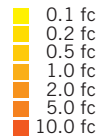
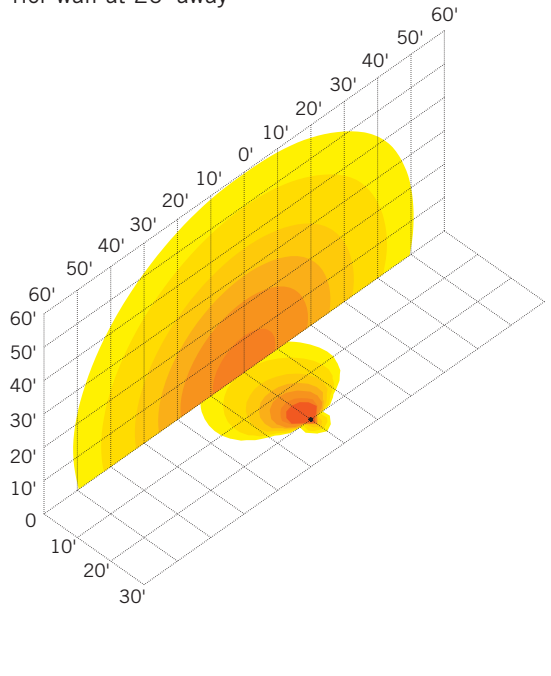



KT-FLED60-R1A-UNV-8CSB-VDIM-W

COMPACT 60W GENERAL-PURPOSE LED FLOOD LIGHT

PHYSICAL SPECIFICATIONS

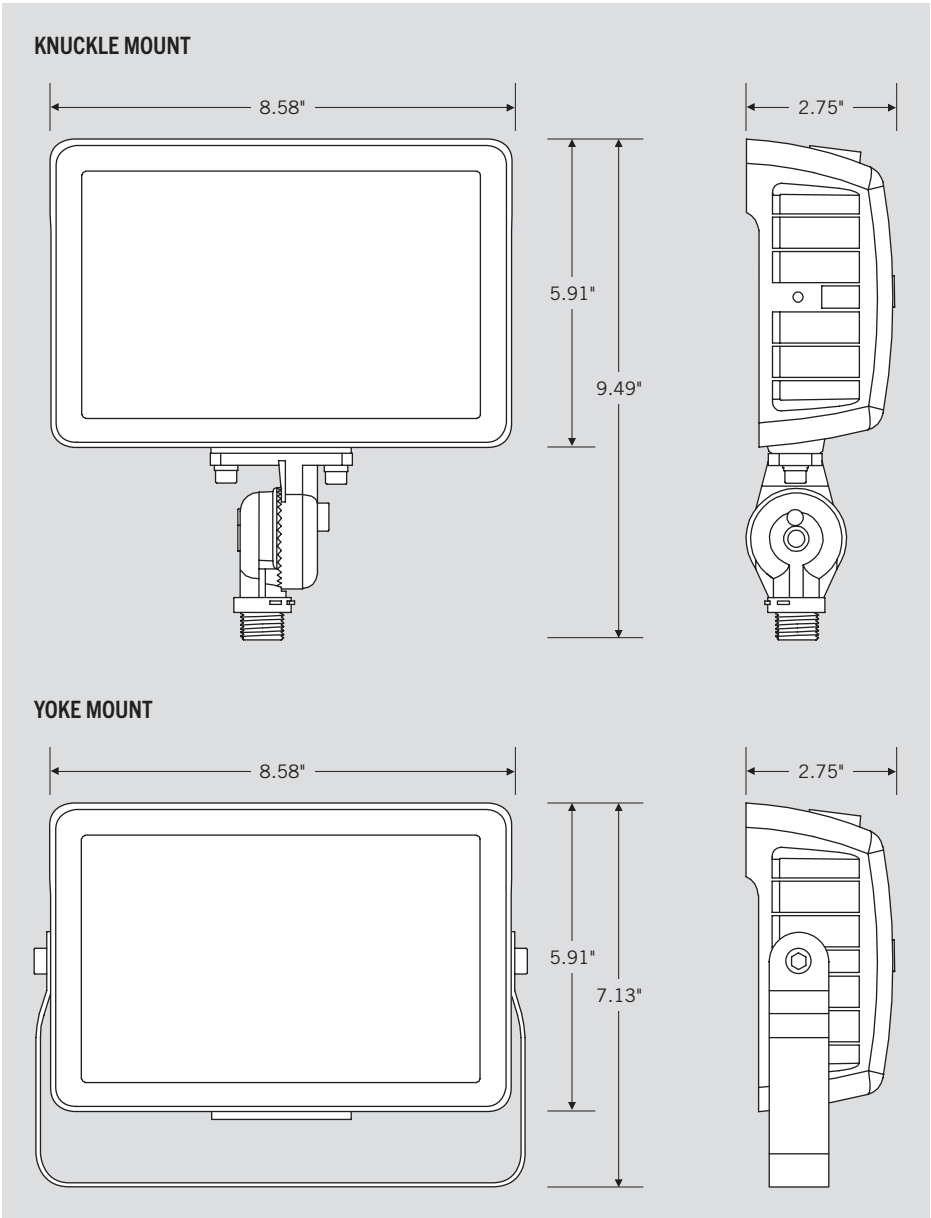

	EPA
Mounted Vertical	0.42 sq/ft
Mounted Horizontal	0.20 sq/ft
Mounted 45°	0.44 sq/ft



KT-FLED60-R1A-UNV-8CSB-VDIM-W

COMPACT 60W GENERAL-PURPOSE LED FLOOD LIGHT

GENERAL SETUP INSTRUCTIONS

GENERAL WIRING DIAGRAM

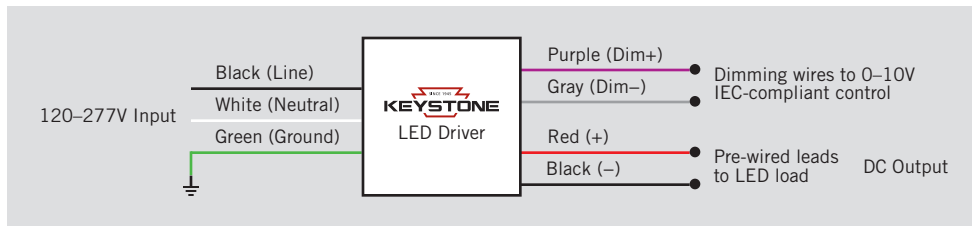

Caution: Before installing, make certain that AC power to the fixture is off.

Caution: The electrical rating of this product is 120-277V. Installer must confirm that there is 120-277V at the fixture before installation.

PHOTOCELL ENABLE/DISABLE

This fixture is equipped with a dusk-to-dawn photocell behind the translucent knock-out (KO) cover. Adjust the dip switch to enable (ON) or disable (OFF) the photocell function (see illustrations to the right). Fixture comes preset with photocell enabled unless otherwise noted.

COLOR SELECT (CCT) ADJUSTMENT

This fixture is equipped with Color Select technology. There is an adjustable dip switch behind the translucent knock-out (KO) cover to change CCT between 5000K, 4000K, and 3000K (see illustrations to the right). Fixture comes preset at 5000K unless otherwise noted.

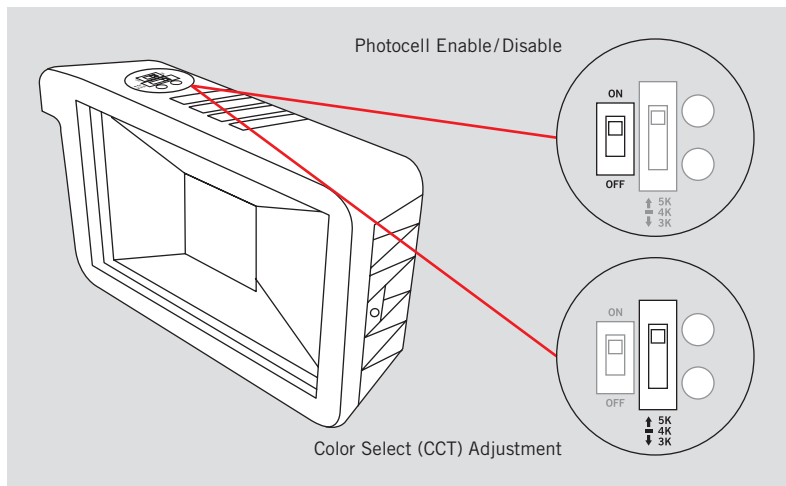

ACCESSORIES (SOLD SEPARATELY)

Catalog Number	Description
KT-FLED-SM-1-KIT	Flood Light Wall Mount Kit
KT-FLED-RC-4-W	4" Round Flood Light Junction Box Cover, White
KT-FLED-RC-4	4" Round Flood Light Junction Box Cover, Bronze



KT-FLED60-R1A-UNV-8CSB-VDIM-W

COMPACT 60W GENERAL-PURPOSE LED FLOOD LIGHT

ORDERING INFORMATION

CATALOG NUMBER	PACK QTY.	EASY CODE	UPC
KT-FLED60-R1A-UNV-8CSB-VDIM-W	1	KCM-51	843654128993

CATALOG NUMBER BREAKDOWN

KT-FLED60-R1A-UNV-8CSB-VDIM-W

1	2	3	4	5	6	7	8	9	10	11	12	13																																			
<p>1 Keystone Technologies</p> <p>2 Fixture Type</p> <p>3 LED Lamp</p> <p>4 Max Wattage</p> <p>5 Shape</p> <p>6 Style</p> <p>7 Distribution</p> <p>8 Mounting</p> <p>9 CRI</p> <p>10 Color</p> <p>11 Color Select Designation</p> <p>12 Dimming</p> <p>13 Housing Color</p>	<p>2 Fixture Type</p> <table border="1" style="width: 100%; border-collapse: collapse;"> <tr> <td style="width: 15%; text-align: center;">F</td> <td>Flood</td> </tr> <tr> <td style="text-align: center;">WP</td> <td>Wallpack</td> </tr> </table> <p>7 Distribution</p> <table border="1" style="width: 100%; border-collapse: collapse;"> <tr> <td style="width: 15%; text-align: center;">A</td> <td>Wide (7 × 7)</td> </tr> <tr> <td style="text-align: center;">B</td> <td>Narrow</td> </tr> <tr> <td style="text-align: center;">C</td> <td>Very Narrow</td> </tr> </table> <p>10 Color</p> <table border="1" style="width: 100%; border-collapse: collapse;"> <tr> <td style="width: 15%; text-align: center;">40</td> <td>4000K</td> </tr> <tr> <td style="text-align: center;">50</td> <td>5000K</td> </tr> <tr> <td style="text-align: center;">CS</td> <td>Color Select</td> </tr> </table> <p>12 Dimming</p> <table border="1" style="width: 100%; border-collapse: collapse;"> <tr> <td style="width: 15%; text-align: center;">VDIM</td> <td>0-10V</td> </tr> </table>	F	Flood	WP	Wallpack	A	Wide (7 × 7)	B	Narrow	C	Very Narrow	40	4000K	50	5000K	CS	Color Select	VDIM	0-10V	<p>5 Shape</p> <table border="1" style="width: 100%; border-collapse: collapse;"> <tr> <td style="width: 15%; text-align: center;">R</td> <td>Rectangular</td> </tr> </table> <p>8 Mounting</p> <table border="1" style="width: 100%; border-collapse: collapse;"> <tr> <td style="width: 15%; text-align: center;">UNV</td> <td>Universal</td> </tr> </table> <p>11 Color Select Designation</p> <table border="1" style="width: 100%; border-collapse: collapse;"> <tr> <td style="width: 15%; text-align: center;">A</td> <td>3500K, 4000K, 5000K</td> </tr> <tr> <td style="text-align: center;">B</td> <td>3000K, 4000K, 5000K</td> </tr> <tr> <td style="text-align: center;">C</td> <td>3000K, 3500K, 4000K, 5000K</td> </tr> <tr> <td style="text-align: center;">D</td> <td>TBD</td> </tr> </table> <p>13 Housing Color</p> <table border="1" style="width: 100%; border-collapse: collapse;"> <tr> <td style="width: 15%;"></td> <td>Bronze</td> </tr> <tr> <td style="text-align: center;">B</td> <td>Black</td> </tr> <tr> <td style="text-align: center;">W</td> <td>White</td> </tr> </table>	R	Rectangular	UNV	Universal	A	3500K, 4000K, 5000K	B	3000K, 4000K, 5000K	C	3000K, 3500K, 4000K, 5000K	D	TBD		Bronze	B	Black	W	White	<p>6 Style</p> <table border="1" style="width: 100%; border-collapse: collapse;"> <tr> <td style="width: 15%; text-align: center;">1</td> <td>Non-Cutoff</td> </tr> <tr> <td style="text-align: center;">2</td> <td>Full-Cutoff</td> </tr> </table> <p>9 CRI</p> <table border="1" style="width: 100%; border-collapse: collapse;"> <tr> <td style="width: 15%; text-align: center;">8</td> <td>>80</td> </tr> <tr> <td style="text-align: center;">9</td> <td>>90</td> </tr> </table>	1	Non-Cutoff	2	Full-Cutoff	8	>80	9	>90
F	Flood																																														
WP	Wallpack																																														
A	Wide (7 × 7)																																														
B	Narrow																																														
C	Very Narrow																																														
40	4000K																																														
50	5000K																																														
CS	Color Select																																														
VDIM	0-10V																																														
R	Rectangular																																														
UNV	Universal																																														
A	3500K, 4000K, 5000K																																														
B	3000K, 4000K, 5000K																																														
C	3000K, 3500K, 4000K, 5000K																																														
D	TBD																																														
	Bronze																																														
B	Black																																														
W	White																																														
1	Non-Cutoff																																														
2	Full-Cutoff																																														
8	>80																																														
9	>90																																														