

# KT-WDLED-XA-BN-TRIM

## INTERCHANGEABLE TRIM FOR SLIM WAFER DOWNLIGHTS

**DESCRIPTION**

Interchangeable Trim for Series A  
Slim Wafer Downlights | Brushed Nickel

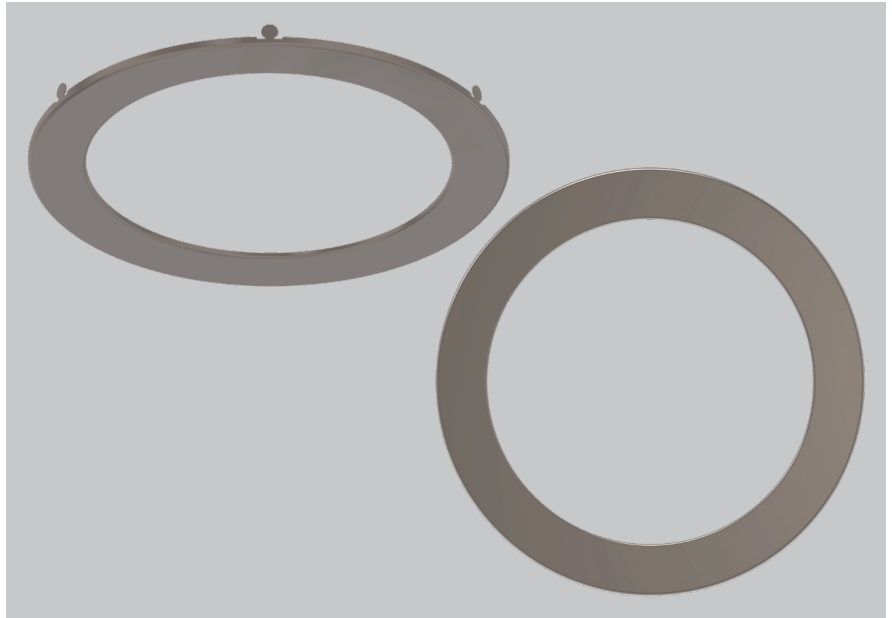

**PHYSICAL SPECIFICATIONS**

Size	D1 (Diameter 1)	D2 (Diameter 2)	H1 (Height 1)	H2 (Height 2)
4"	4.85"	3.02"	0.44"	0.18"
6"	6.91"	4.90"	0.44"	0.18"
8"	8.98"	6.82"	0.44"	0.18"



# KT-WDLED-XA-BN-TRIM

INTERCHANGEABLE TRIM FOR SLIM WAFER DOWNLIGHTS

### ORDERING INFORMATION

Catalog Number	Pack Qty.	UPC	Easy Code
KT-WDLED-4A-BN-TRIM	1	843654139340	IEJ-60
KT-WDLED-6A-BN-TRIM	1	843654139357	PJM-11
KT-WDLED-6A-BR-TRIM	1	843654139388	RXK-07

### CATALOG NUMBER BREAKDOWN

# KT-WDLED-XA-BN-TRIM

1
2
3
4
5
6
7

- 1** Keystone Technologies
- 2** Wafer Downlight
- 3** LED Technology
- 4** Nominal Size
- 5** Series A
- 6** Brushed Nickel
- 7** Trim

#### 4 Nominal Size

4	4"
6	6"
8	8"